

Ordinance # 201
Vacated 2nd Ave of J. Collar's Add. to Dodge City, Kans
Passed by council and approved by Mayor Sept 21, 1910.
First published in the Globe Republican
Sep. 29 - 1910.
Carl Turner
Reg. of Deeds.

Jacob Collar's
addition to
Dodge City,
1877.

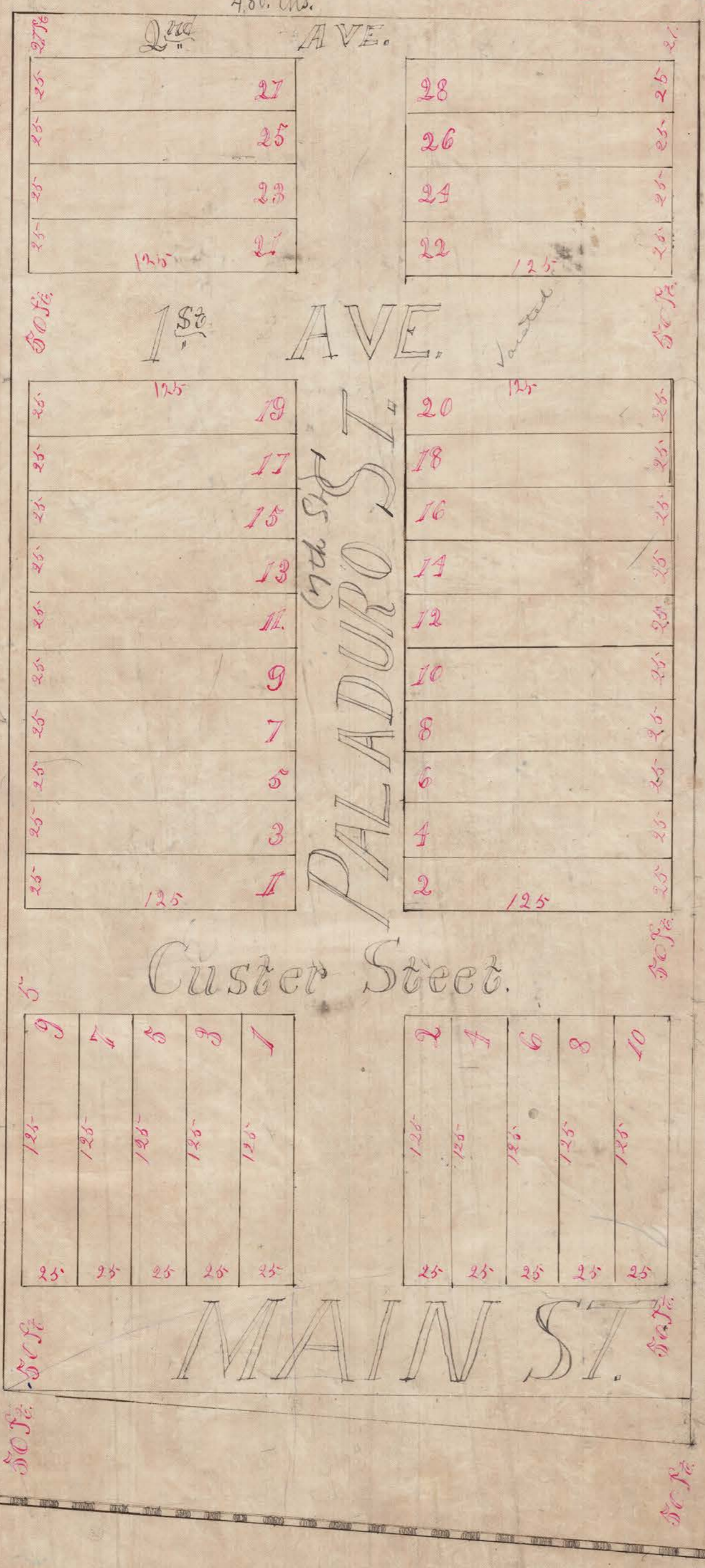

I Jacob Collar of Dodge City Kansas, do hereby certify that I have this 16th day of April One Thousand Eight hundred and Seventy seven, filed with the Register of Deeds in and for the County and State aforesaid a True and correct Plat of the Collar's Addition to the Dodge City Town Site described per County Surveyor certificate,
Jacob Collar.

State of Kansas }
County of Ford }
Before me the undersigned a Register of Deeds in and for the County and State aforesaid, this day came Jacob Collar who is personally known to me to be the identical person who signed the foregoing map and acknowledged the same to be his voluntary act and deed for the purpose therein set forth.
In Testimony Whereof I have hereunto set my hand and official seal the day and year last above written.



James Langton
Register of Deeds.

State of Kansas }
County of Ford }

This map was filed for record this 16th day of April A.D. 1877 at 9 o'clock A.M. and duly recorded in Book A of Deeds at page No 445.

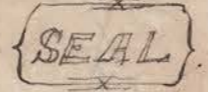

James Langton
Register of Deeds.

This Plat embraces all that parcel of Land known as Lot number one the same being the east tract or parcel of land in a certain tract of land surveyed and platted and recorded on page 297 in book A of Deeds in the office of the Register of Deeds of Ford County, Kansas the said tract lying, being and situate in Lots 3 and 4 of Section 26 and in the South 1/2 of the south west 1/4 of Section 26 Township 26 and Range 25 west of the 6th Principal Meridian being in Ford County and State of Kansas. Said Lot Number One is the same Plat commencing at a point 50 fifty feet North from the center of the A.T. & S.F. R.R. Tract and running north along the west line of Dodge City 1000 chs thence west 480 chs thence south to within 50 ft of the center of the A.T. & S.F. R.R. Tract thence east along the south line of said track to place of beginning.

W.S. McCarty County Surveyor of Ford County

I hereby certify this to be a true and correct plat of the Collar addition to the Dodge City Town site as compiled from original survey made Sept. 29th 1876.

W.S. McCarty County Surveyor
Ford County